

Hawaiian Telecom Internet Quick Start Guide

Page 4111N

Welcome

Thank you for choosing Hawaiian Telecom High-Speed Internet, your connection to a whole new level of Internet enjoyment!

Your broadband service will be activated on the due date you were given when you placed your order.

This guide will walk you through step-by-step installation instructions. Getting started is easy!

For more information

Visit hawaiiantel.com/internetsupport or call our 24/7 Local Internet Support Team at 643-6111.

Looking for FREE WiFi access points? Hawaiian Telecom offers the most in the state. Click on the WiFi Locations link at hawaiiantel.com/wifi for a complete listing.

6 Personalize Your Security Settings

To personalize the security settings on your Wireless Gateway, open your web browser, type "<http://home>" in the address bar and hit **Enter**. You will be taken to a new screen – see Figure 2.

Click on the **Wireless** link. You will be taken to a new screen – see Figure 3.

In the box labeled **Network Name (SSID)**, enter the new name you would like to call your network.

To change your WiFi security code, scroll down the page and click on the circle in front of **Set custom encryption key**. Enter a new security code in the box. The security code is case sensitive and may contain up to 31 alphanumeric characters (no spaces).

You will be asked for a password. Enter the original WiFi security code (WiFi key) located on the side of your Wireless Gateway.

To save your changes, scroll down the page and click **Save**.

Figure 2

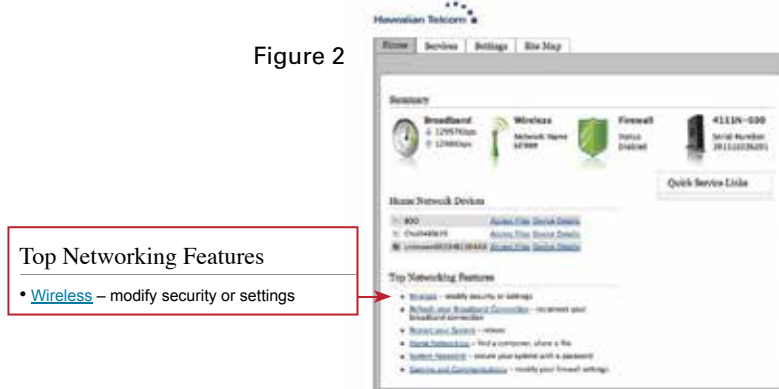
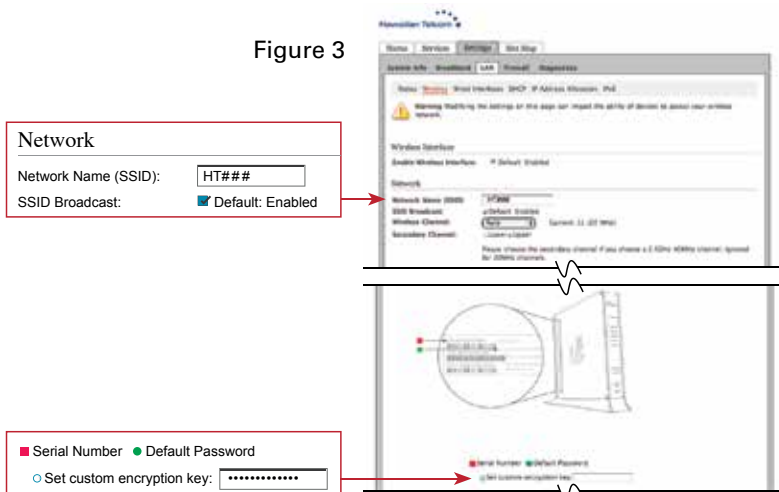
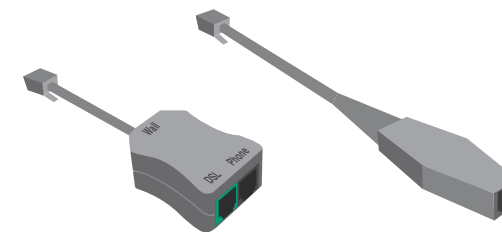

Figure 3



What's included



Combo Splitter / Filter (1) Phone / Fax Filter (3)

Wireless Gateway (1)



Green Data Cable (1)



Yellow Ethernet Cable (1)



AC Power Adapter (1)



Installation Diagram

1 Splitter and Filters

Plug the green Data Cable directly into a live phone jack. If you also want to connect a telephone to the same phone jack, first plug in the combo Splitter/Filter then plug the Data Cable into the jack labeled DSL. To prevent static, install a Phone / Fax filter on all corded and cordless phones, fax machines and devices in your home that share the same phone line. If you need more filters, call 643-6111.

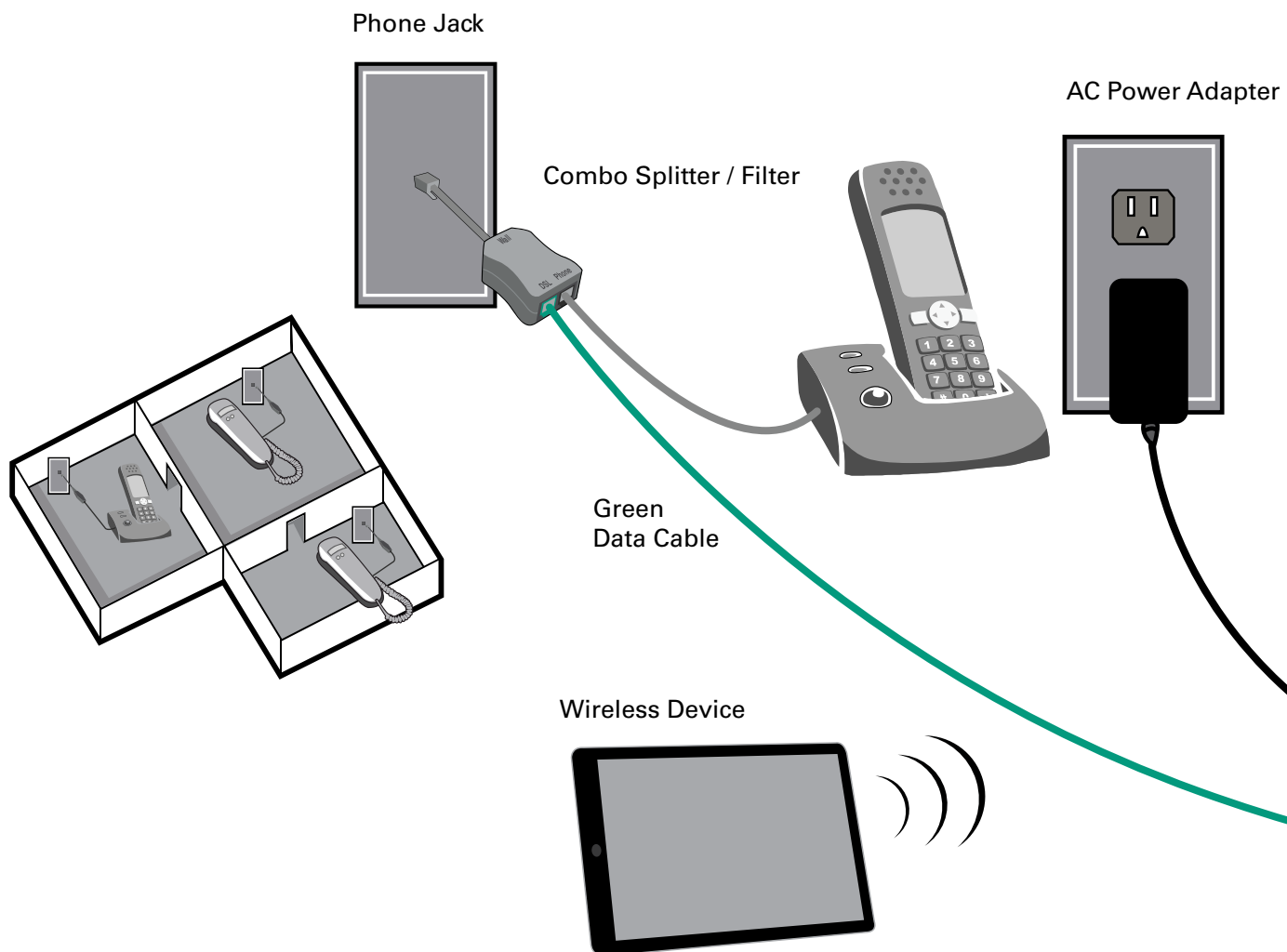

2 Connect Wireless Gateway

Connect the other end of the green Data Cable to the Wireless Gateway. Connect the AC Power Adapter to the Wireless Gateway and plug it into a power outlet.

3 Connect Computer

Connect your computer to the Wireless Gateway with the yellow Ethernet Cable. You can directly connect up to 4 computers or printers to the Wireless Gateway. For information on how to set-up and use a wireless connection, refer to Step 5.

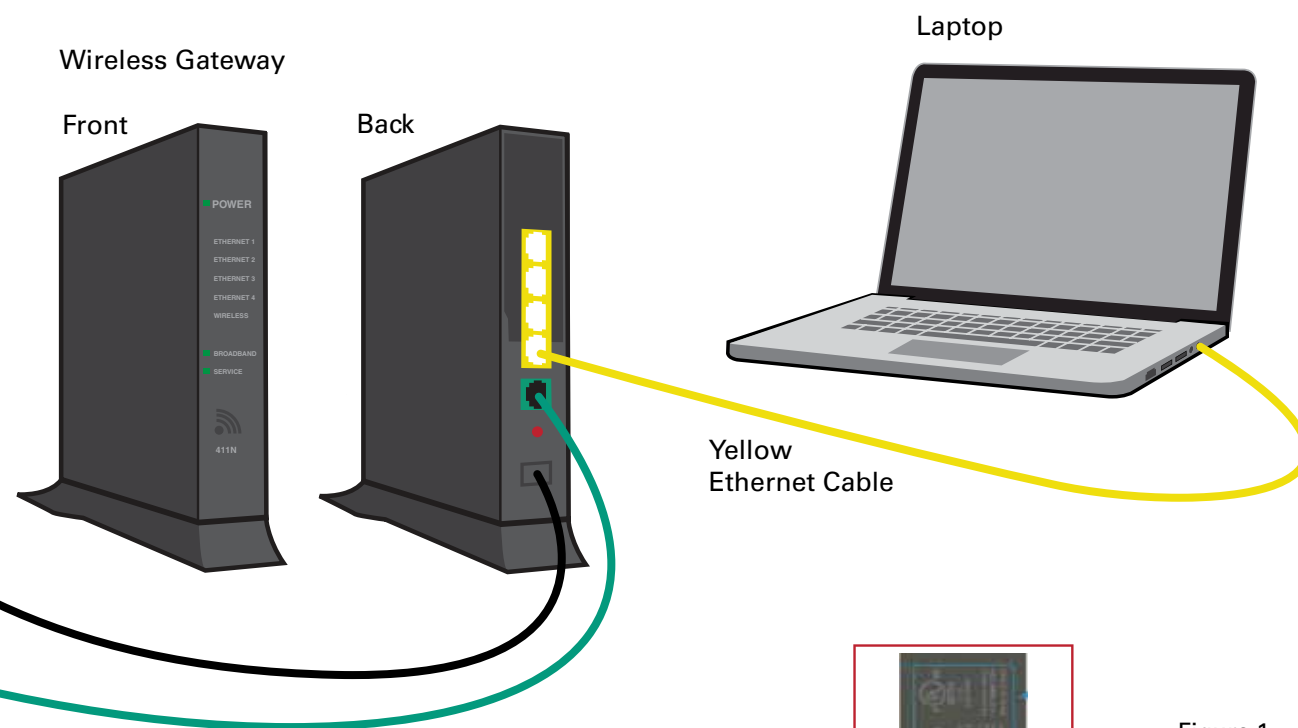

4 Test Your Connection and Register

After you've completed Steps 1-3, wait two minutes then check the lights on the front of the Wireless Gateway. The **Power** and **Broadband** lights should be steady green. The **Service** light may be blinking or steady green. If the lights on your Wireless Gateway aren't lighting up correctly, call 643-6111 for assistance.

Go to hawaiiintel.com/internetsupport to test your connection and register for your free email account.

5 Set-up Your Wireless Network

Go to hawaiiintel.com/internetsupport for instructions on how to connect a wireless device (smartphone, tablet, laptop, etc.) to your network.

For your protection, the Wireless Gateway is programmed with default security settings. The default Network Name (SSID) and WPA2 WiFi security code (WiFi Key) are on the side of your Wireless Gateway. See Figure 1.

To personalize the security settings, refer to Step 6 on the opposite side of this guide.

